

AirPort Extreme Card Replacement Instructions

Follow the instructions in this sheet carefully. Failure to follow these instructions could damage your equipment and void its warranty.

Note: Online instructions are available at <http://www.info.apple.com/installparts/>.

Tools Required

This procedure requires the following tools:

- Coin
- Strong non-marring nylon, plastic, or wood, flat-blade/probe tool (optional)

Opening the Computer

Warning: Always shut down your computer before opening it to avoid damaging its internal components or causing injury. After you shut down the computer, the internal components can be very hot. Let the computer cool down before continuing.

1. Place your computer on a clean, flat surface.
2. Shut down your computer and wait five minutes before continuing.
3. Unplug all cables from the computer.

4. Turn over the computer, and use a coin to release the battery lock. **(Figure 1)**
5. Lift the battery out of the battery bay.

Figure 1



6. Touch a metal surface inside the battery bay to discharge static electricity built up on your body. **(Figure 2)**

Important: To avoid electrostatic discharge, always ground yourself by touching the inside of the battery bay before you touch any parts or install any components inside the computer. To avoid static electricity building back up in your body, do not walk around the room until you have completed the installation and closed the computer.

Figure 2



Installing the Replacement AirPort Extreme Card

1. Pull outward on the slot to open the AirPort Extreme Card door. **(Figure 3)**

Figure 3



2. If an optional AirPort Extreme card is already installed, pull out the card's clear plastic pull tab, tucked underneath. **(Figure 4)**

Figure 4



3. Gently disconnect the AirPort Extreme antenna cable. **(Figure 5)**

Important: Do not pull the cable.

Figure 5



4. Use the pull tab to pull out the card. **(Figure 6)**

Figure 6



-
5. Slide the replacement AirPort Extreme Card into the slot, as shown. **(Figure 7)**
Figure 7



6. Push the card into the slot until fully seated. **(Figure 8)**
Figure 8



7. Connect the end of the antenna cable to the card. **(Figure 9)**

Figure 9



8. Loop the clear plastic tab down around the antenna cable and tuck it into the slot under the card so that it secures the cable. **(Figure 10)**

Figure 10



9. Make sure the card is fully inserted, as shown in the second image. **(Figure 11)**

Figure 11

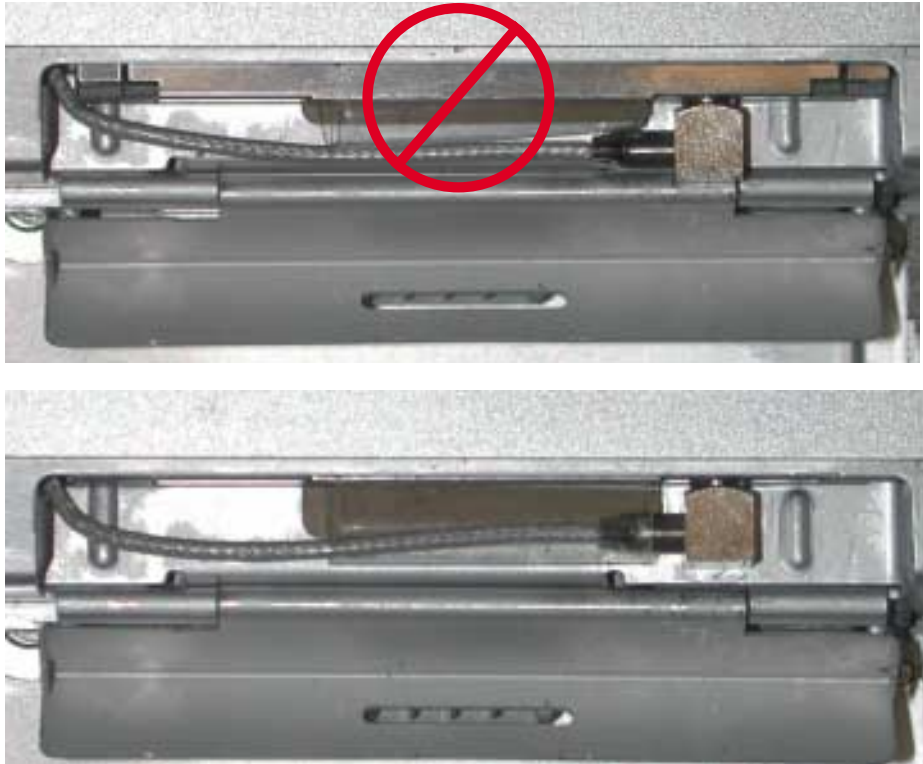

10. Close the AirPort door. **(Figure 12)**

Figure 12



Closing the Computer

1. Install the battery back in the battery bay.
2. Reconnect all cables and restart your computer.

Warning: Never turn on your computer unless all of its internal and external parts are in place and it is closed. Operating the computer when it is open or missing parts can damage your computer or cause injury.

Note: If the AirPort Extreme card is not being recognized in the Network pane in System Preferences, shut down your computer, remove the battery, open the AirPort Extreme card door and again push in on the card to verify that it is fully seated.

 **Apple Computer, Inc.**

© 2003 Apple Computer, Inc. All rights reserved.

This document is protected under U.S. Copyright Law and International Treaties, and no part of this document may be reproduced in any form without written permission from Apple.

Apple is not responsible for typographical, printing, or inadvertent errors.

Apple Computer, Inc.
1 Infinite Loop
Cupertino, CA 95014-2084
USA
+ 1 408 996 1010
<http://www.apple.com>

Apple and the Apple logo are trademarks of Apple Computer, Inc., registered in the U.S. and other countries. PowerBook and AirPort are trademarks of Apple Computer, Inc.